

# **SEAVIEW**

**ELEVATE YOUR ELECTRONICS**

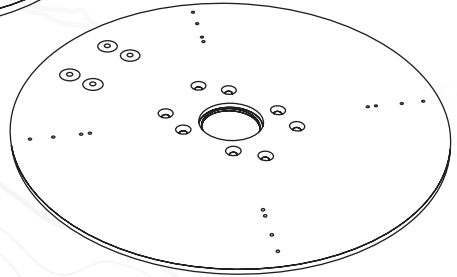
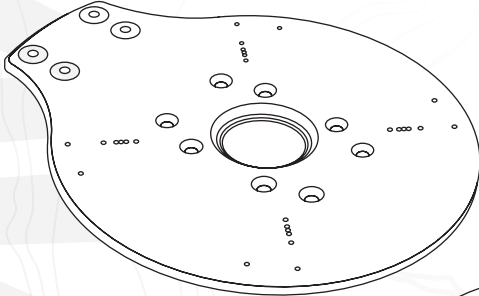

## **INSTALLATION INSTRUCTIONS**

For Seaview Modular Top Plate:

**ADA-S1, ADA-S2**

Refer to website for most up to  
date instructions and videos.

**[WWW.SEAVIEWGLOBAL.COM](http://WWW.SEAVIEWGLOBAL.COM)**

# PARTS INCLUDED

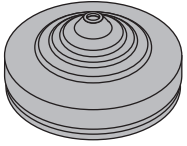

**X1**

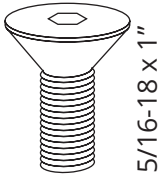

**X8**

5/16-18 x 1"

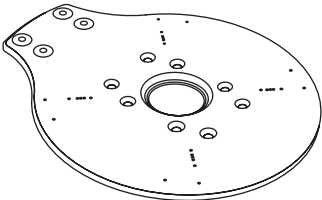

**X1** ADA-S1

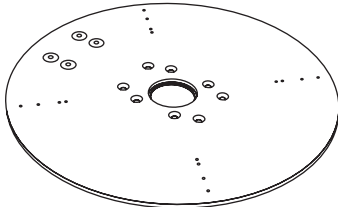

**ADA-S2**

---

# TOOLS NEEDED

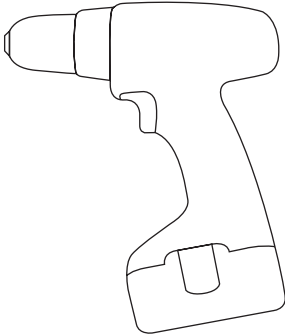

Sudbury Elastomeric Marine Sealant is recommended. To purchase call 800-655-7922 or visit [www.seaviewglobal.com](http://www.seaviewglobal.com)

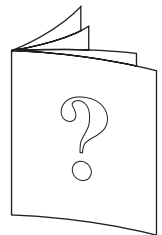
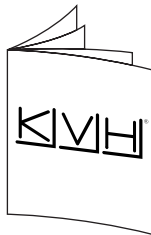
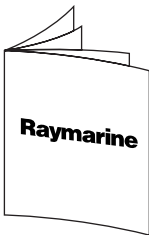

# 1

Locate the Make and Model of your satellite dome on this chart and determine which drill hole number is yours. Then place the Drill Template on top of the Seaview Top Plate. Refer to the Seaview website or the most up to date chart.

### ADA-S1 Drill Template Chart

1	<b>Thrane</b>	SAILOR FB500, FLEET 55+
2	<b>VDO</b>	Ocean Line 132
3	<b>Intellian</b>	i1, i2
4	<b>Glomex</b>	20" - 27" satellite domes
5	<b>KVH</b>	M1, LTE-1
6	<b>VDO</b>	Ocean Line 337
7	<b>Sea-King</b>	1500HD
7	<b>Sea-Tel (Cobham)</b>	C14
7	<b>KVH</b>	M2, M3, V3-IP, TV3
7	<b>Intellian</b>	i3
7	<b>Raymarine</b>	37STV

### ADA-S2 Drill Template Chart

1	<b>Intellian</b>	i6, i6P, k6, d6, S6HD, FB500
1	<b>KVH</b>	M7, M7SK, HD7, V7, TV6, FB500(26"), V3-IP(24")
2	<b>VDO</b>	Ocean Line 345, 360, 445, 460
3	<b>Intellian</b>	i4, i4P, k4, d4, i5
3	<b>KVH</b>	M5, TRAC 50, TV5, FB250(18"), V7IP, VHTS
3	<b>Raymarine</b>	45STV
3	<b>SEA-TEL (COBHAM)</b>	ST14, FX150, C18, FX250
4	<b>KVH</b>	TracPhone V7-IP

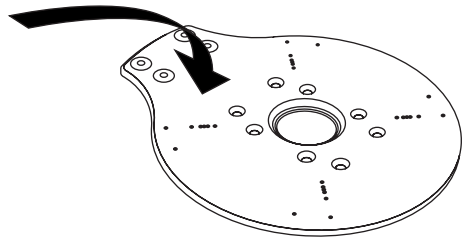
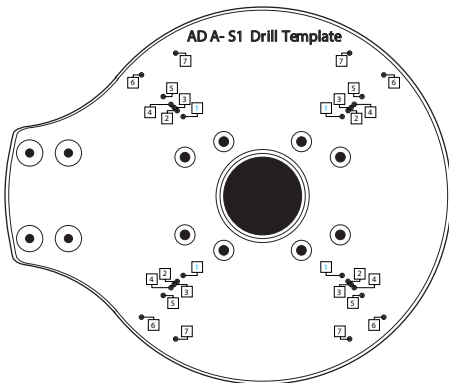

# 2

Use the Drill Template to identify and mark the four holes on your Seaview Top Plate.

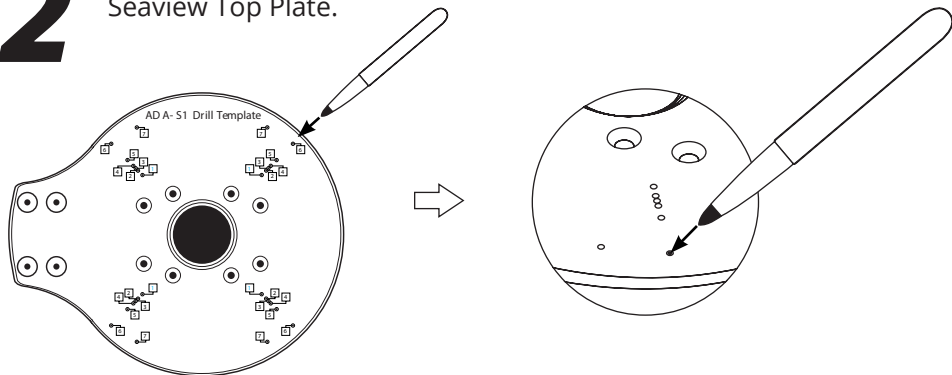

# 3

Drill the four marked holes. Be sure to check with your marine electronic manufacturers manual to determine what size drill bit is needed.

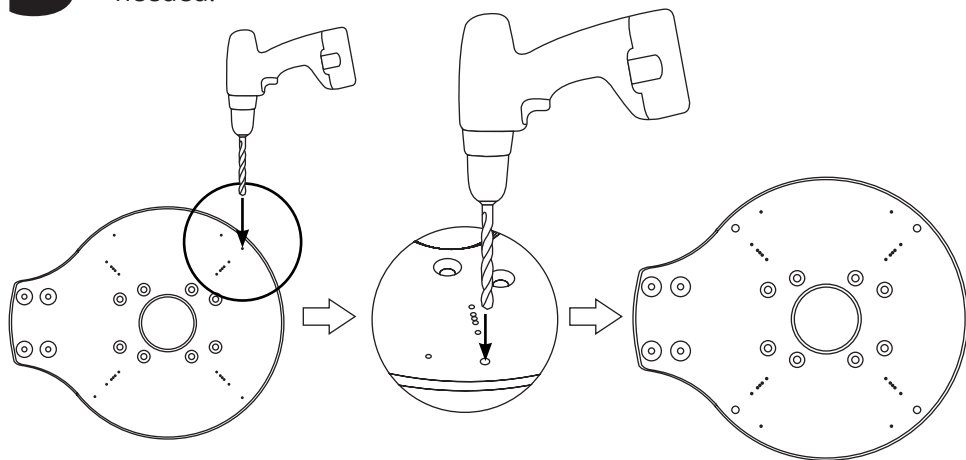

# 4

Apply marine adhesive sealant along the lip in the center hole on the Top Plate. Route the cabling through the center hole in the Top Plate. Then insert through the black rubber grommet. When inserting the black rubber grommet into the Top Plate be sure that the center lip falls into the groove in the grommet.

## TIP

Place the connector of the cable into a plastic bag. Apply Vasoline to the exterior of the plastic bag. Then try routing the connector/cable through the black rubber grommet.

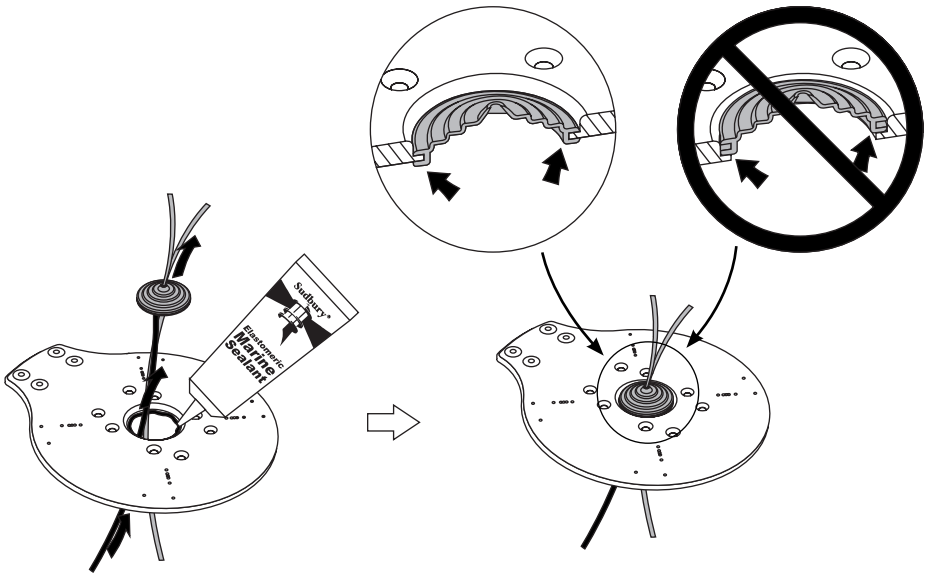

# OPTIONAL ACCESSORIES

Call 800-655-7922 or visit [www.seaviewglobal.com](http://www.seaviewglobal.com) for available accessories.

## LIGHT BARS

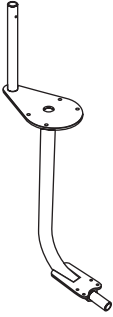

### LTB-SF

Fits search lights, thermal cameras and satdomes.

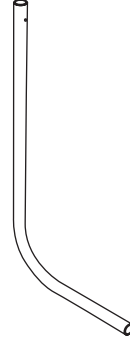

### LTB-S

Fits 20" or smaller satdomes.

## LIGHT BAR TOPS

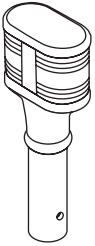

### LTBP-1197

Perko Incandescent Light.

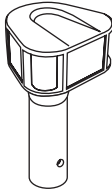

### LTBA-7800

Attwood LED Light.

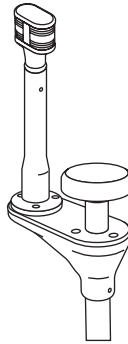

### LTBU1A1197

Light Bar Top with Perko Incandescent Light, can fit GPS.

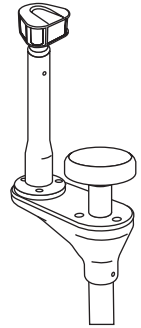

### LTBU1A800

Light Bar Top with Attwood LED Light, can fit GPS.

## SPREADER KIT

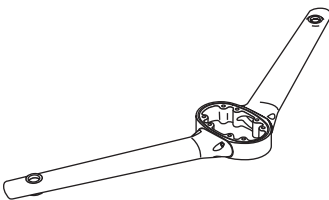

### SP1-MOD or SP2-MOD

Allows user to mount GPS units or antennas onto a Seaview Modular Mount.

***THIS PAGE INTENTIONALLY LEFT BLANK.***

# ADA-S1

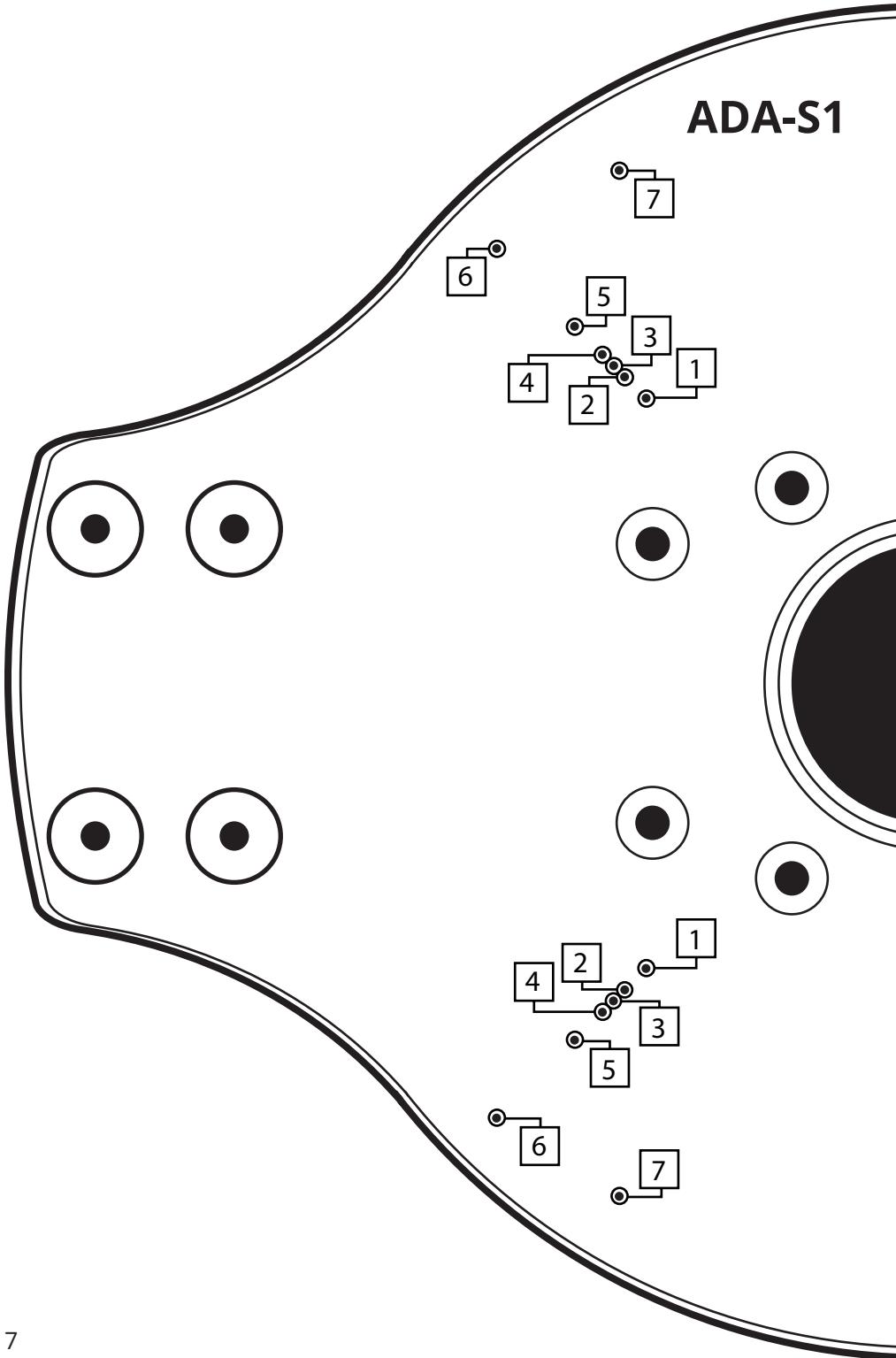



NOT to scale

# Drill Template

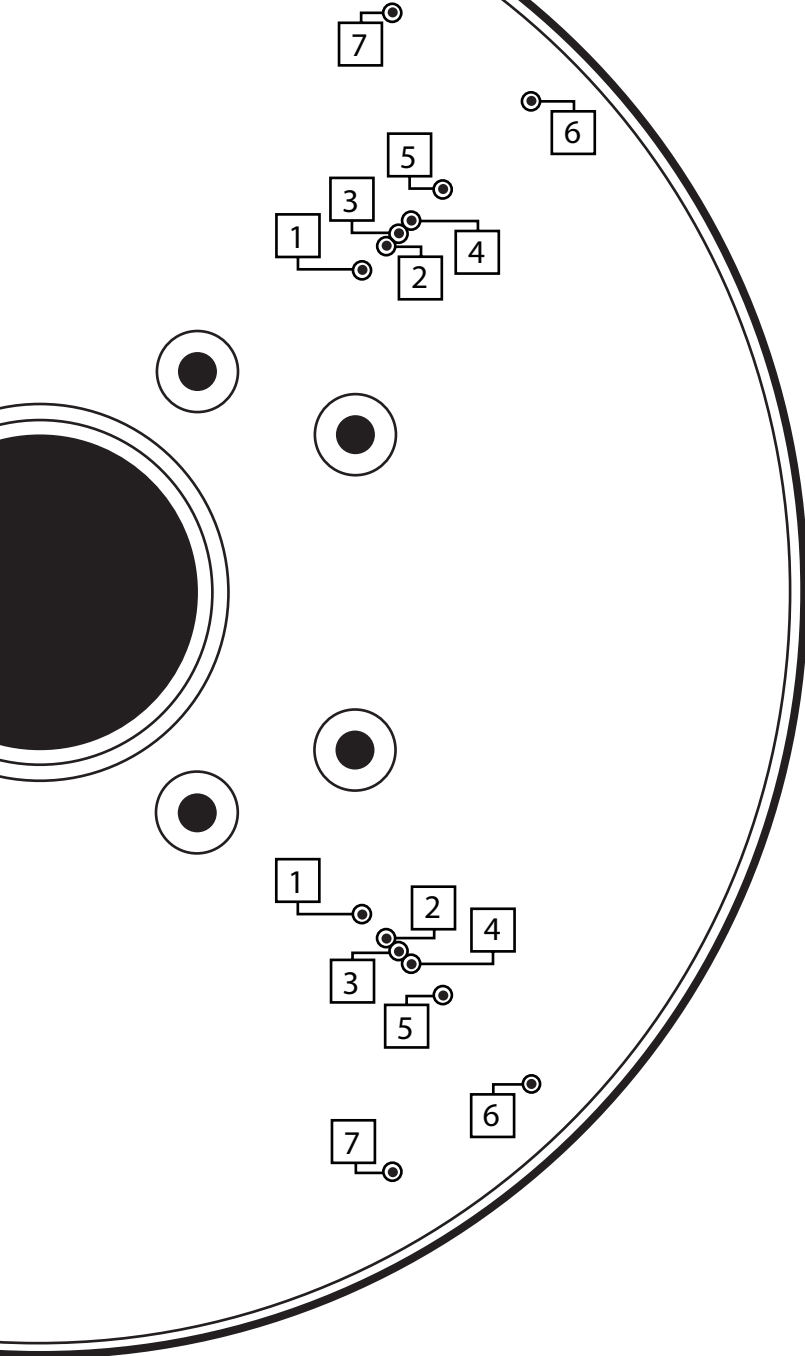

# ADA-S2

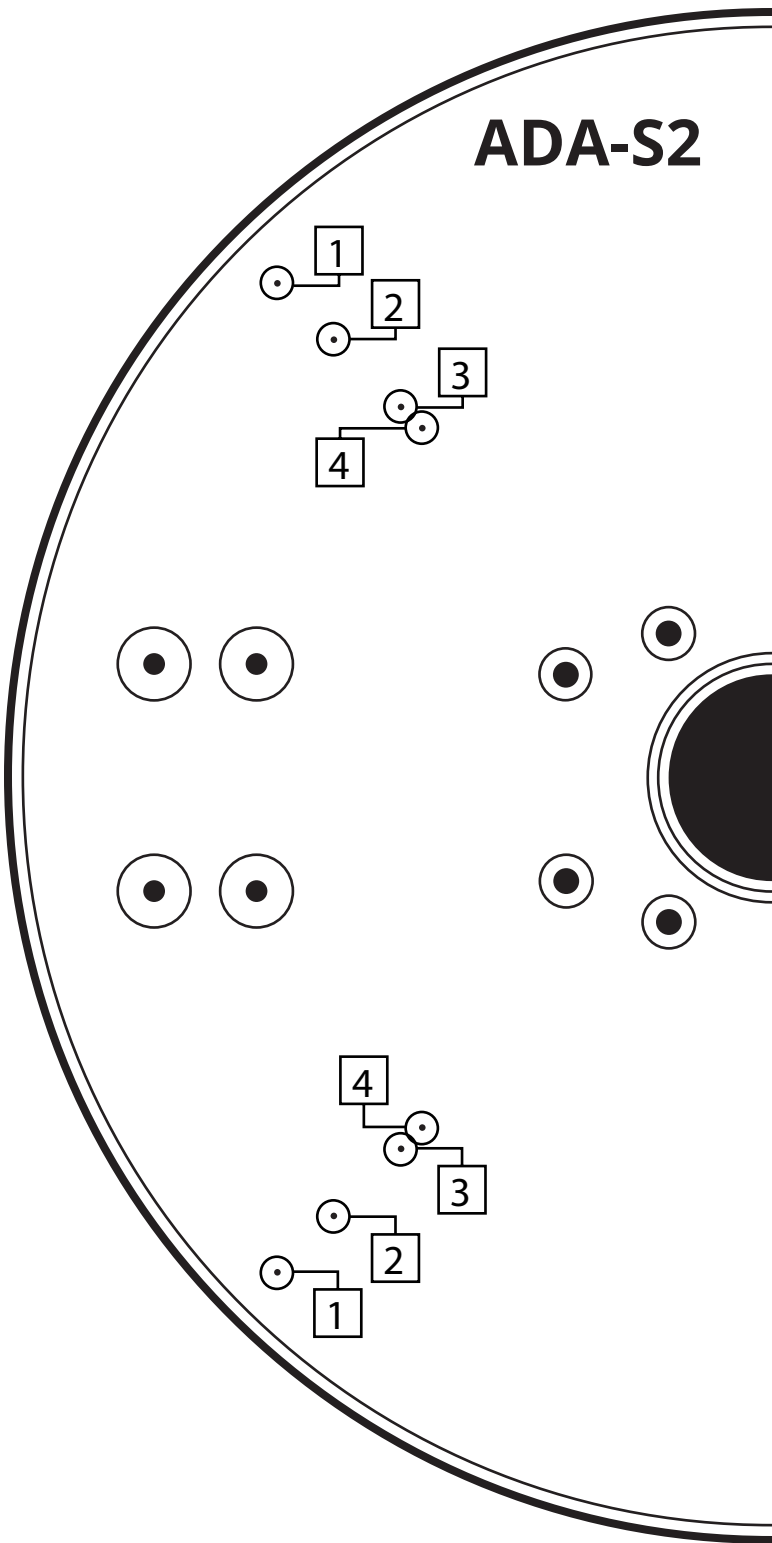

NOT to scale

# Drill Template

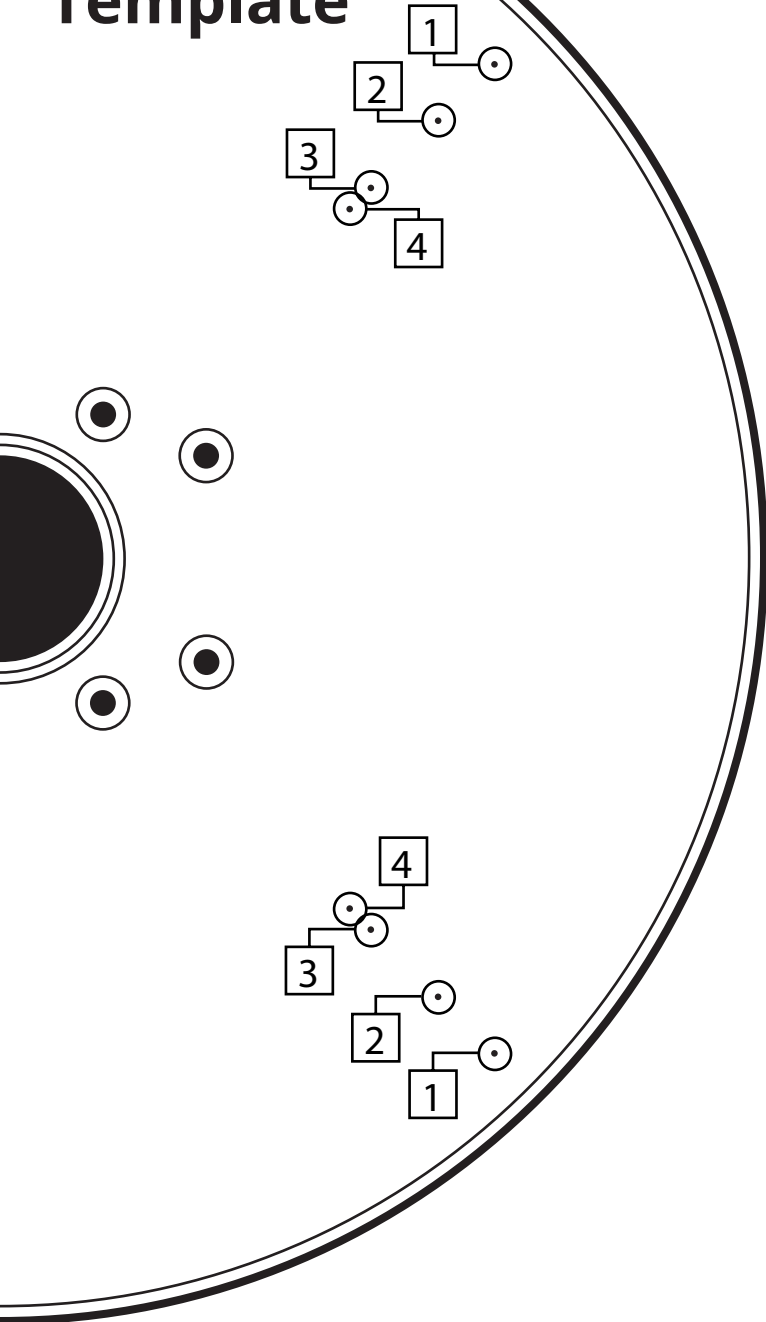

The background of the entire page is a light gray topographic map with white contour lines. The lines are irregular and wavy, representing elevation changes across a landscape. The map is centered and covers the entire area.

***SEAVIEW***///  
***ELEVATE YOUR ELECTRONICS***

***SEAVIEW***///

Tel: 800-655-7922  
[www.seaviewglobal.com](http://www.seaviewglobal.com)

***EUROPEAN OFFICE***

Tel: +33 4 94 53 27 70  
[www.seaviewprogress.com](http://www.seaviewprogress.com)

4-122318